

Gasconade County SWCD

July 2024—Volume 35, Issue 1

June 7, 2024

Goodbye to a legend!

Diana Mayfield retired after 27 years of dedicated service to the Gasconade County Soil and Water Conservation District.

She will be missed, but continues to serve as a consultant. So you may see her in the office from time to time.

We wish her all the best in her future endeavors!



Board of Supervisors:

Luke Mangrum—Chairman
Brian Rost—Vice-Chairman
Joel Wehmeyer—Treasurer
Harvey Hesemann—Member
Matt Herring—Secretary

NRCS Staff:

Mark Brandt—District Conservationist
Megan Brown—Resource Conservationist
April Aholt—Soil Conservation Technician

District Staff:

Manager Patty Burt—District Specialist I
Technician Sarah Berkemeyer—District Specialist IV

MDC Staff:

Ryan Westcott—Private Lands Conservationist
Scott Williams—Fisheries Biologist
Aaron Holsapple—Forester
Tracey Prenger—Public Lands Conservationist

This newsletter is partially funded by the
1/10th of 1% Parks and Soil and Water Sales Tax.



Patty Burt, District Manager
District Specialist I

Sarah Berkemeyer, District Technician
District Specialist IV



Luke Mangrum, Board Chairman

Brian Rost, Board Vice-Chairman



Harvey Hesemann, Board Member

*SWCD
Staff and
Board
Members*



Joel Wehmeyer, Board Treasurer



Matt Herring, Board Secretary

2024 Plat Books

Celebrating 60 Years of the Gasconade County Soil & Water Conservation District

A tri-fold book featuring current aerial and plats, AND a plat from 1962.

Stop in at the office to pick up your copy. ALSO, the holidays are coming, and they make great gifts!!

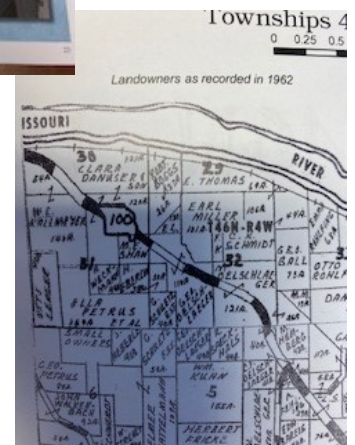
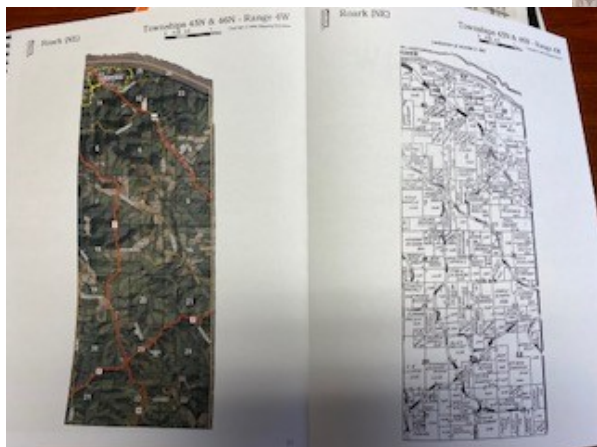
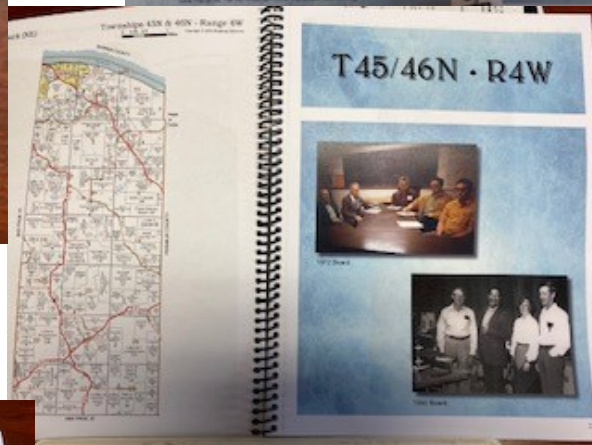
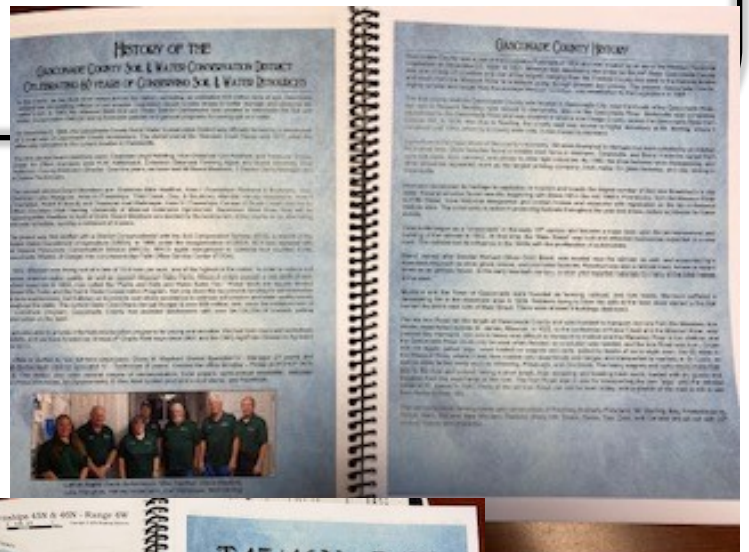
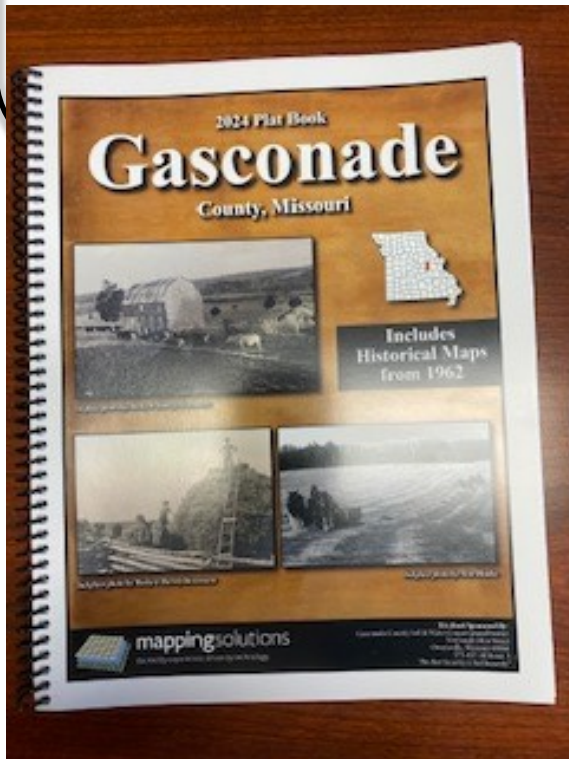

2024
Grazing School
 Sponsored by Osage
 County SWCD,
 NRCS, University of
 Missouri Extension, and
 Missouri Department of
 Conservation
 Aug. 21, 22, &23
 Barefoot Event Center
 1214 East Lee Street
 Linn, MO 65051

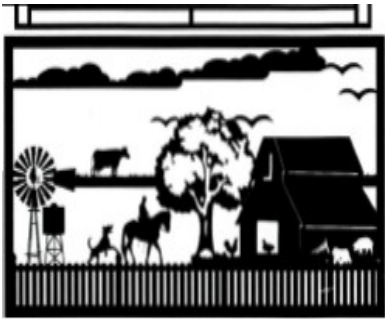

Management Intensive Grazing

In this day and time, we must all learn to manage efficiently to stay competitive. This is particularly true in the forage and livestock world. Our management techniques determine the success of our project. Management intensive grazing includes understanding the components of a successful grazing system and learning the management techniques to make the system work for you.

Sound grazing management includes four basic factors. These factors will be the basis of a total system approach. Managing a grazing system to reach its full potential should be the goal of all farms.

Management intensive grazing is a goal driven approach to forage-livestock management. In this grazing school, you will learn to set goals and be given information to help you achieve these goals.

DSP-3 Planned Grazing System

The state cost-share program has implemented a cost-share practice to assist landowners in developing a grazing system. This practice is referred to as DSP-3. The DSP-3 practice has stipulations to qualify for cost-share funds. One of these stipulations include the attendance of a certified management intensive grazing school.

This school is an opportunity to increase grazing capacity, and also meet the requirement of attending a grazing school for the DSP-3 cost-share practice participation.

USDA is an equal opportunity provider, employer, and lender.

Fee: 1 person/\$165.00; Additional person/\$60.00 (only one set of materials)

For questions contact Blake Bockting at (573) 897-3797 ex.3

Join us!
 in
 Cape Girardeau, MO
 September 16-18, 2024

For the
29th Annual
 Missouri State
 Women in Ag Conference

Conference Schedule

Monday, September 16, 2024

9:00-12:00 & 1:30-5:00 Registration
 9:00-5:00 Vendors
 12:00-1:30 **Lunch & Opening Session**
 1:30-4:30 Workshops
 • Equine Soundness & Chiropractic Adjustment
 • Farm Safety/Chainsaw Safety • Self First-Aid
 • Preparing Food at Home to Sell
 • Pumpkins & Gourds • Stephens Bee Company
 6:00-7:00 Banquet
 with Special Guest John Stephens, retired English
 Teacher and Madrigal Actor
"Rock & Roll" Theme Banquet
Pick Your Era for a Fun Night of Dress-Up!
 7:00 Entertainment with "Jams" featuring DJ music
 from the 1950's to the 2000's

Tuesday, September 17, 2024

6:00-7:15 Free Hot Breakfast
 7:15 Load buses
 **** Buses Leave at 7:30 am Sharp ****
 7:30-4:00 Ag Tours and Catered Luncheon
 5:30-7:00 Kick Back Menu
 (hot food & cold drinks) OR dinner on your own
 4:30-10:00 Hospitality room available
 7:00-9:00 BINGO (Free with Prizes!)

Wednesday, September 18, 2024

6:00-9:00 Free Hot Breakfast
 Check out no later than 11:30 am
 9:00-11:00 Closing Ceremony/
 Passing the Torch/Door Prizes

Tour Information

Tuesday 7:30 - 4:00

Meier Horseshoe Pines: Take a tour of this Christmas tree farm in a horse-drawn wagon. You'll want to visit their Market and Christmas Shop too.

Vanduser Cotton Gin: Currently owned by the Harvest Foundation, it employs and educates at-risk youth from all over the United States, which help to gin an average of 24,000+ bales of cotton, produced in the surrounding area.

Triple D Farms: A multi-generational family owned operation, their current crop mix consists of corn, cotton, soybeans and peanuts.

Willow & Company: What started out as 40 acres by their grandfather in 1938, has grown to a 7,100 acre operation of cotton, rice, soybeans, corn and wheat in Stoddard, Scott and New Madrid Counties

Cape County Alpacas: Enjoy a hands-on alpaca feeding experience or just unwind and watch the animals. They are so calm and rejuvenating. Shop their farm store for unique alpaca gifts.

Castor River, Inc./Rice & Mill: Going against the grain with a different approach to farming.

Send us your
 Lady Landowner Nominations
wilma.carlyon@swcd.mo.gov

Or mail to :
 Wilma Carlyon
 812 Progress Dr.
 Farmington, MO 63640

**** WARNING ****
 WE WILL BE VISITING A PEANUT FARM

USDA is an Equal Opportunity Provider, Employer and Lender
 Funds have been provided by the Missouri Parks, Soils & Water

Pollinator Workshop

Presenter: Ryan Westcott, Missouri Department of Conservation Private Land Conservationist for Cole, Osage, and Gasconade Counties, 1315 E Main St, Linn MO 65051. Office: 573-897-2138 ext 3032.



August 16, 2024
9:00 am—1:00 pm

Lincoln University G.W. Carver Farm
3804 Bald Hill Rd
Jefferson City MO 65101



Establishing Native Pollinators & Wildflower Habitats



Importance of Native Grasses and Wildflowers and Benefits for Wildlife

Long-term Management of Established Stands

Species Identification

Cost Share Opportunities

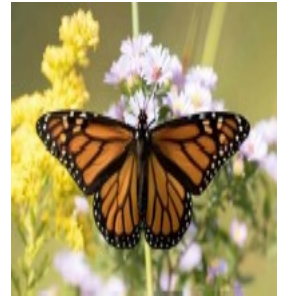

Link to Registration: <https://mdc-event-web.s3licensing.com/Events/EventDetails/200920>

9th Annual Event

Women in Agriculture

Thursday, September 5, 2024 White Mule Winery
2087 US-50, OWENSVILLE, MO 65066

Schedule of Events

- 3:00-5:30 pm Open Registration and Vendors
- 3:30-4:15 pm *Introduction to Beekeeping*
Presented by Mike Wuerffel
- 4:15-5:00 pm Visit with Area Vendors with Local Products
- 5:00-5:45 pm *Wildlife Diseases: What you should know*
Presented by Dr. Sherri Russell, MDC State Veterinarian
- 6:00 pm Dinner by White Mule Winery
- 7:15 pm Kylie Epperson, Keynote Speaker



LIKE US ON **facebook** @omg.wia

Federal Funding Opportunities through the Natural Resources Conservation Service (NRCS)

By Megan Brown, Resource Conservationist

The USDA-NRCS offers several federal cost-share programs to improve the soil, water, air, plant, and animal resources on your property. One commonly used program is the Environmental Quality Incentives program (EQIP), which offers cost-share to implement resource conservation practices such as grazing systems, wildlife/ pollinator habitat, forest management, and cover crops. Another program available is the Conservation Stewardship Program (CSP). This program is tailored for producers who have already implemented conservation practices on their property and would like to enhance what they already have or incorporate additional practices into their operation. EQIP and CSP, unlike state cost-share, are competitive programs. The sign-up period is always open, but applications are only reviewed and ranked during limited batching periods. The batching cut-off for 2025 funding will occur this Fall, although the exact cut-off date has not yet been announced. **For inquiries stop by the office at 316 S. Olive St, Owensville, MO 65066 or call 573-437-3478 x3 and ask for Megan.**

FSA News

Hello Gasconade County producers, here at the FSA office we have been very busy with the recent acreage reporting deadline, and we know many of you have had a delayed planting season and continue to try to get hay harvested around the recent rains. Please see the information below for FSA news. Jayme, Mackenzie, and Hannah are all regularly in the Gasconade office and look forward to visiting with you, and as always, feel free to stop by, call or email the office with any questions at 573-437-3478 ext.2 or by email at moowensvil-fsa@usda.gov.

Interested in FSA Programs/Updates?

We continue to look for ways to spread information about disaster sign-ups and FSA programs that are available to producers, the best way to stay up to date with this information is to subscribe to the monthly newsletter and to sign up for text alerts.

To receive FSA text alerts:

Text: MOGASCONADE OR MOOsage OR MOMaries

To: FSANOW (372-669)

To receive the monthly newsletter:

Email: Call or visit the FSA office and provide them with a current email address.

Livestock Indemnity Program: Producers may have experienced livestock death losses due to extreme cold temperatures earlier this year or lightning from recent storms. The Livestock Indemnity Program (LIP) provides assistance to eligible producers for livestock deaths in excess of normal mortality caused by adverse weather. For livestock losses to be considered eligible, producers must provide evidence that livestock death(s) were due to an eligible adverse weather event or loss condition and file a notice of loss (CCC-852) as soon as the loss is apparent but no later than 60 calendar days following the program year in which the loss occurred.

In addition to filing a notice of loss, producers will be required to provide documentation. Examples of acceptable documents may include but are not limited to:

- Beginning inventory at each loss event - inventory records, veterinarian documentation/bills, birthing records, production records, balance sheets, or other similar documents
- Death documentation- dated photos, veterinarian records, insurance documentation, 3rd party certifications- CCC-854
- Normal mortality documentation

December 15 is the deadline to report fall-seeded crops including wheat, barley, rye, and triticale. Due to the current workload in the office, please call to schedule an appointment if possible.

Farm Storage and Equipment Loans: If you are looking to upgrade any storage or handling equipment, you should consider the FSFL program. With commodity prices being lower than last year & the price of hay, now may be a good time to put up a new grain bin or a hay shed. Once approved, rates are fixed for the life of the loan and can range from 3-12 years depending on the loan amount. Current rates are 4.375%- 4.625% depending on the term of the loan.

Announcing Farm Loan Programs Office Hours

Farm Loan Program Staff will implement office hours in Osage/Maries and Gasconade County. Staff will be available every 4th Thursday of the month in Owensville and every 2nd and 4th Wednesday in Linn. If possible, please call ahead to set an appointment and to discuss any records or documentation that might be needed during your appointment. The Farm Loan Program Staff for Gasconade producers can be reached at 636-649-3127 or by emailing Kallie.turner@usda.gov. The Farm Loan Program Staff for Osage/Maries producers can be reached at 573-893-5196 or by emailing jessica.Groose@usda.gov.

Location

Urban-St Louis
Lincoln Co-Troy
Montgomery Co- Montgomery City
Urban-St Louis Public Library
Gasconade Co- Owensville
Osage/Maries Co-Linn

Schedule

Every Wednesday
1st Thursdays
2nd Tuesdays
3rd Tuesdays
4th Thursdays
2nd and 4th Wednesday

Signup Periods for the following SWCD cost-share programs are now open!

Cover Crops: May 15—September 15. If you wish to apply legumes, turnips or radishes, they must be on the ground by September 25, so apply early. You must have a two crop rotation and no-till is required for the following production crop. A soil health analysis is also required on new acreage being addressed.

Spring Seedings: August 15-January 15. Permanent Vegetative Establishment (Grass Seeding). Assistance for lime and fertilizer, eligible seed, seeding operation and seedbed prep. Conventional till-



Partnership Award Recipient

Gary Miller

Conservation Family Award Recipient

Sanford Kohlbusch



Volunteer Award Recipient

Owensville FFA



Gasconade County SWCD

314 Olive Street
Owensville, MO 65066
(573) 437-3478 ext. 3
FAX: 855-842-7890

STD
U.S. Postage
PAID
Owensville, MO
Permit No. 8

Upcoming Dates to Remember

August 6	Board Meeting, USDA Service Center, 6:30 pm
Aug 15—Jan15	Spring Seedings Signup Period
<i>August 21-23</i>	<i>Osage County Grazing School, Linn</i>
September 3	Board Meeting, USDA Service Center, 6:30 pm
<i>September 5</i>	<i>OMG Women In Ag, White Mule Winery</i>
September 15	Cover Crops Signup Period Deadline
<i>September 16-18</i>	<i>MO State Women In Ag, Cape Girardeau, SWCD staff out of office</i>
<i>October 2-3</i>	<i>4th Grade Field Days, White Mule Winery</i>
October 14	Columbus Day, office closed
November 5	Board Meeting, USDA Service Center, 6:30 pm
November 11	Veterans Day, office closed
November 28	Thanksgiving Day, office closed
December 2-4	District Training Conference, SWCD staff out of office
December 10	Board Meeting, TBD
December 25	Christmas Day, office closed
January 1, 2025	New Year's Day, office closed
January 20	Martin Luther King Day, office closed

Visit us on the web at <https://mosoilandwater.land/gasconade>

Gasconade County SWCD Equipment

A NEW LEASE AGREEMENT MUST BE SIGNED EACH YEAR AND ON FILE AT THE SWCD OFFICE BEFORE EQUIPMENT CAN BE RENTED.

Drills: Minimum of 10 acres applies. Proof of vehicle insurance is required at the time of pickup.

- ◇ 2019 1590 John Deere 10 ft no-till drill! \$12 per acre charge. Located at 3325 Hwy 19 Owensville. Call Gary Miller at **573-690-9065** to schedule.
- ◇ 2022 706NT Great Plains 7 ft no-till drill with warm season box is located at the SWCD office. \$12 acre. To schedule call **573-473-3478 x 3**.

Located at the SWCD Office:

- ◇ Burn Equipment - \$50 deposit, \$10 use charge
- ◇ ATV Equipment (Seeder, Sprayer) - \$100 deposit, \$20 a day each piece
- ◇ ATV Warm Season Grass Seeder—no charge—Donated by Quail Unlimited
- ◇ Soil Probe - no charge